

317 Princes Highway ST PETERS, NSW



Whisper Quiet! Amazing Renovation + Double Garage & Walk in Vault!

Don't look away or you will miss this exceptional opportunity!

People tend to get put off when a home is located on the Princes Highway, but savvy buyers will be immediately impressed from the moment you walk beyond the front door.

Conveniently located approximately 7km from the CBD, it is just a stroll to Sydney Park, King Street Newtown's vibrant cafe culture, Sydenham and St Peters station.

Features include:

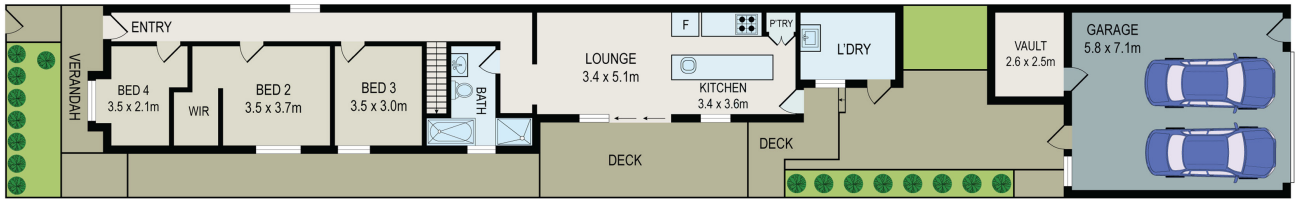

GROUND FLOOR

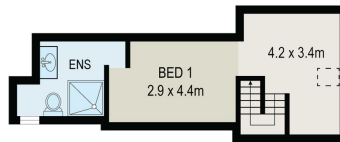

LOFT

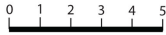

All information contained herein is gathered from all sources we believe to be reliable. However we cannot guarantee its accuracy and interested parties should rely on their own enquiries.

