



602/55 Princes Hwy ST PETERS, NSW



3



2



2

Absolutely Stunning 3 Bedroom 209sqm Penthouse with 2 Car Parking!

Features include:

- Oversized open-plan design flows over one large level occupying the full width of the building.
- Huge bedrooms with terrace access, main with ensuite and walk in robe.
- Separate study area and double tandem parking for two cars.
- Spacious lounge room leads to a large entertainer's terrace with city, Botany Bay and Blue Mountains views.
- Loads of storage and additional storage cage in the basement.
- Beautiful Caesar stone kitchen with Smeg gas cooking, dishwasher, ample bench space, pantry and storage.
- Two large bathrooms with custom cabinetry and bath tub.
- Stylish timber floorboards, full height glass windows, ducted air-conditioning throughout, internal concealed laundry with dryer, video intercom, double basement parking and lift

Inspect:

Tuesday, 2nd March 2021 4:30 - 5:00
Saturday, 6th March 2021 12:00 - 12:30

Auction:

2021-03-13

Details:

16:00:00

SUBLIME
PROPERTY AGENTS

Samuel Theo

Tracy Tallentire

0416 523 226

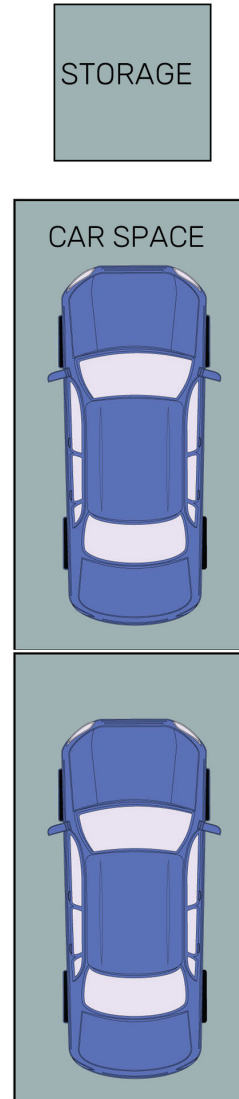
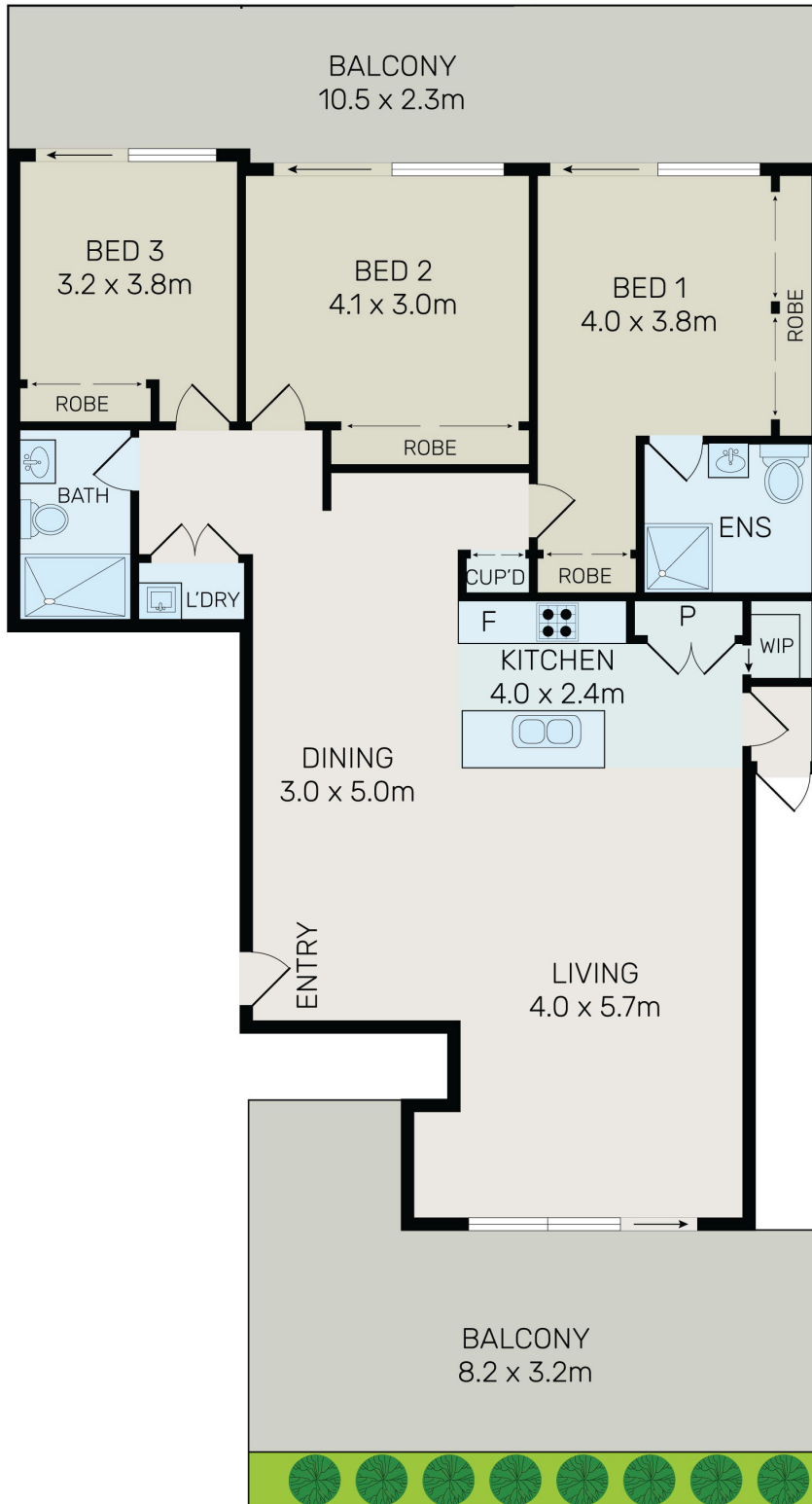

All information contained herein is gathered from all sources we believe to be reliable. However we cannot guarantee its accuracy and interested parties should rely on their own enquiries.



602/55 Princes Highway St Peters