



2/743-745 New Canterbury Road Dulwich Hill, NSW



1



1



1

A Quality, Whisper Quiet Apartment at a Great Price! Spacious, North Facing with

This must be amongst the best value, modern 1 bedroom apartments in the Inner West because it is unique with so much to offer and it is so well priced.

This oversized, whisper quiet apartment is perfectly positioned at the rear of a small, eye-catching boutique block of only 11 (10 apartments and a shop) and it is less than a 10 minute walk to Dulwich Grove Light Rail and Hurlstone Park station.

Features include:

- 8 year young boutique security block of only 10 apartments.
- Easy lift access to a spacious apartment on a total of 89sqm.
- It is a pet friendly building.

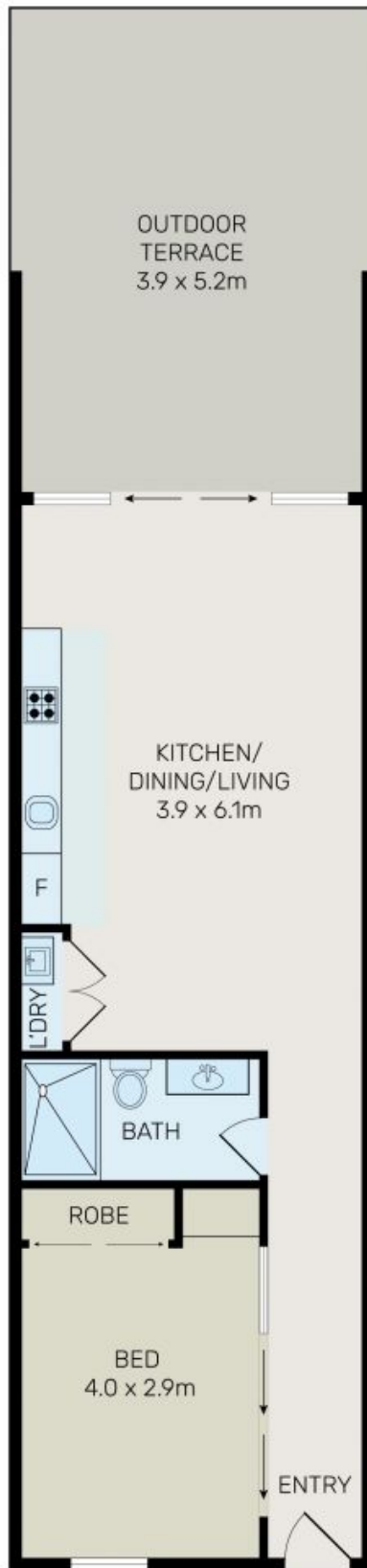

All information contained herein is gathered from all sources we believe to be reliable. However we cannot guarantee its accuracy and interested parties should rely on their own enquiries.



2/743-745 Canterbury Road, Dulwich Hill