

68 Juliett Street Marrickville, NSW



2



1



1

## Light-Filled Federation Charmer with Modern Updates and Parking in a Premier Loc

Perfectly positioned on the Enmore-Marrickville border in one of the Inner West best streets is this deceptively spacious and beautifully renovated, light and airy easy care Federation semi with potential to become a forever home that must be seen to be appreciated.

It seamlessly blends old world charm with modern convenience and quality finishes to suit today's modern lifestyle.

- Renovated, innovative, elegant and in a fabulous location.
- 2 large bedrooms + built-in, separate lounge and dining
- A large white, sleek gas kitchen with a dishwasher.
- Modern big bathroom with a deep shower and a separate laundry.

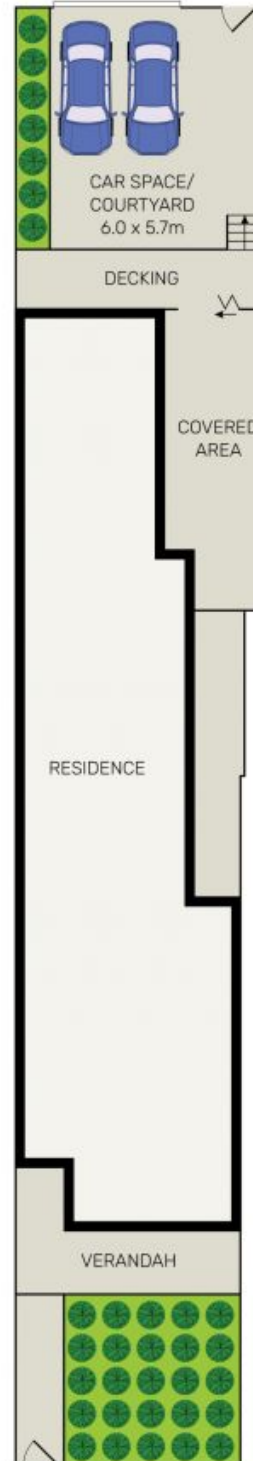
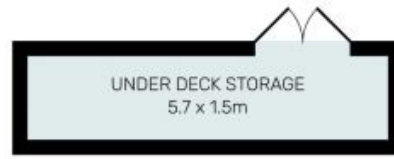
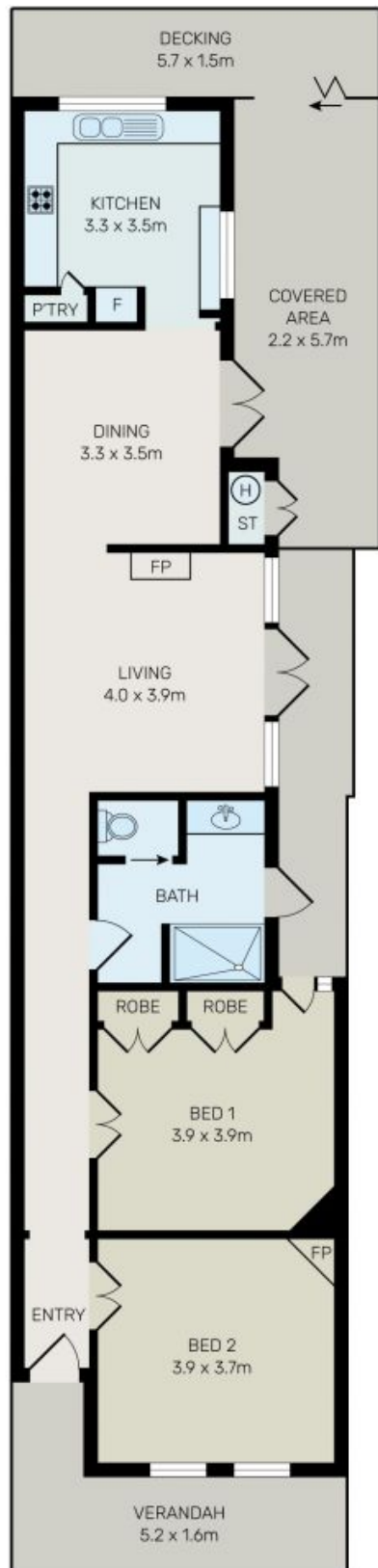

All information contained herein is gathered from all sources we believe to be reliable. However we cannot guarantee its accuracy and interested parties should rely on their own enquiries.



**68 Juliett Street, Marrickville**